



Surge Protection

For comprehensive protection of a luminaire against electrical surges, surge protection shall be installed on the mains supply where required to protect luminaires and drivers from transient voltage damage.

For warranty information visit unios.com/warranty

Please read these installation instructions carefully before installing this luminaire. This product must be installed and maintained by a suitably qualified person/s in compliance with the latest applicable regulations and relevant legislation. Unios does not warrant any claim based on defects or damage caused by misuse, improper installation, improper operation and/or modifications carried out by the purchaser or third parties. This luminaire will not be used as a 'Working light' during construction. This will result in the warranty of the luminaire to be void. For warranty duration, please refer to the data sheet.

Cleaning

Always clean carefully using a soft cloth and a ph-neutral, alcohol-free, non-abrasive cleaning cloth. Clean & Maintain the finish twice a year to avoid rust, oxidation or limescale deposits. If this entire surface is not cleaned correctly, the finish may become uneven.

Do not use abrasive pads, discs, sandpaper and/or high pressure hose/gun to clean the luminaire.

Disposal

Ensure correct disposal of this product (waste electrical and electronic equipment)



Kobe G2 Track Light
Installation Instructions
unios.com/kobetrackims



Kobe G2 Recessed Spotlight
Installation Instructions
unios.com/koberecessedims



Kobe G2

MINI SURFACE MOUNTED SPOTLIGHT

Base Codes	Mini KOBENS08	IP20		
Class III Luminaire only	Material Aluminium	Operating Temp <25°C	Install Person/s 1x	Power 8 Watts



CAUTION – This product must be installed by a qualified installer

Please read instruction manual carefully before installing luminaire

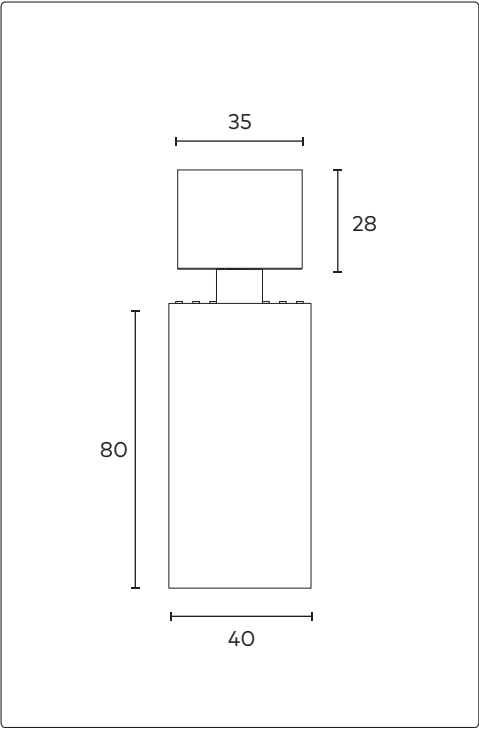

All measurements are in millimetres.

Parts & Accessories

1x

2mm Hex Allen Key
Included

2x

M4 25mm Screws
Included

Product Assembly

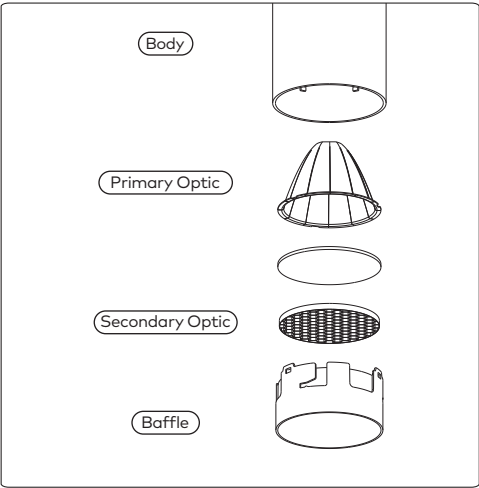

Additional Accessories

Reflectors
See data sheet

Diffusers
See data sheet



Product Installation

CAUTION



Switch off main electrical power prior to installing and powering this luminaire.

Do not open luminaire whilst the main electrical power is active.

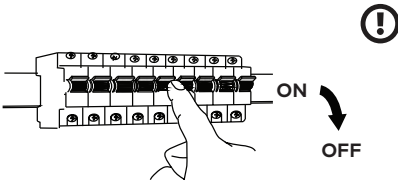

Mounting Bracket

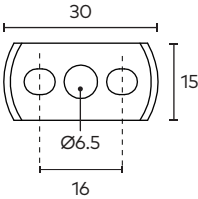

All measurements are in millimetres.

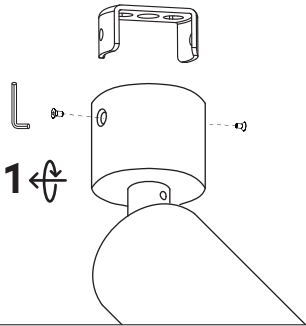

Remove mounting bracket from luminaire using provided allen key.

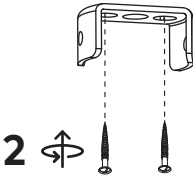

Fasten bracket to surface using supplied 2x M4 screws (Anchors are not included)



Match polarity and connect L-E-N to quick connectors (Refer to wiring)

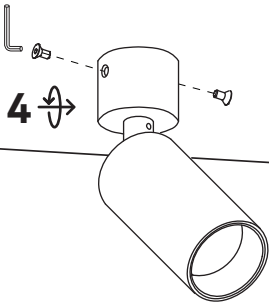

Attach luminaire to mounting bracket and tighten screws using provided allen key

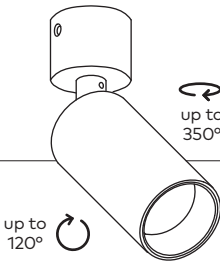

Tilt and rotate product as desired

Wiring

Remote

220-240V
50/60Hz

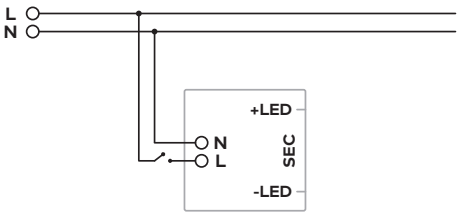

DALI

220-240V
50/60Hz

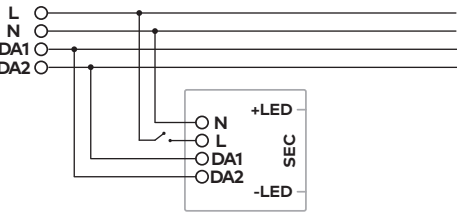

Luminaire Compatibility

Product Code	Output Power	Driving Current	Forward Voltage
KOBENS08	8W	200mA	32-38V

Dimming

Standard models are phase-cut Dimmable. Unios recommends a phase-cut dimmer optimised for LED technology. DALI compatible drivers are also available.

For full list of compatible drivers, see unios.com

